

**RECOMMENDED METHOD OF FITTING A LID TO ANY SIZE CONTAINER
HAVING A SECURITY POST.**

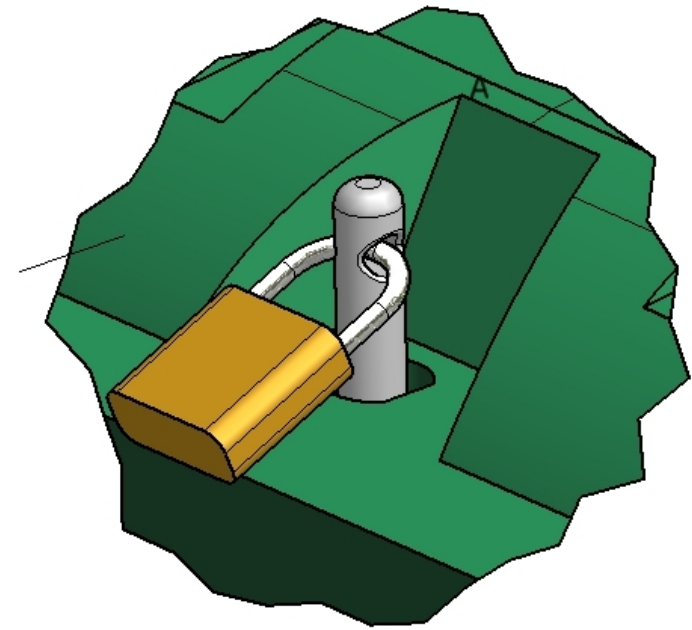

STEP 1:
CONTAINER SHOULD HAVE HINGE
BRACKETS ATTACHED AT THE
BACK AND THE SECURITY POST
AT THE FRONT OF THE
CONTAINER, AS SHOWN.



STEP 2:
THE LID SHOULD BE PLACED ON
TOP OF THE CONTAINER WITH
THE SECURITY POST
PROTRUDING THROUGH THE
LOCKHOLE AS SHOWN. A
PADLOCK IS ATTACHED
THROUGH THE HOLE IN THE
SECURITY POST TRAPPING THE
LID IN SITU.

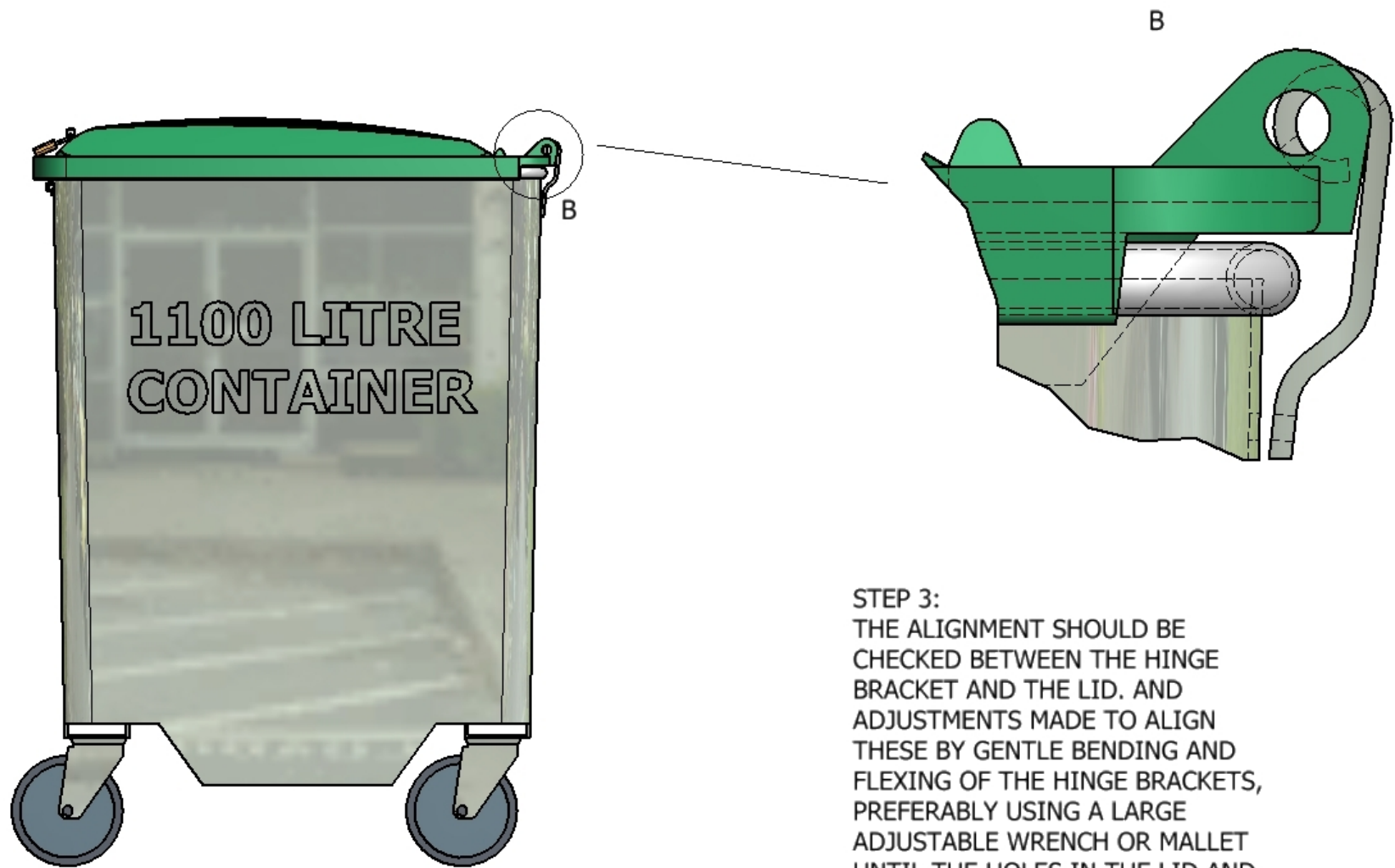

STEP 3:
THE ALIGNMENT SHOULD BE CHECKED BETWEEN THE HINGE BRACKET AND THE LID. AND ADJUSTMENTS MADE TO ALIGN THESE BY GENTLE BENDING AND FLEXING OF THE HINGE BRACKETS, PREFERABLY USING A LARGE ADJUSTABLE WRENCH OR MALLET UNTIL THE HOLES IN THE LID AND HINGE BRACKET ARE IN LINE.



STEP 4:

FINISHED ALIGNMENT OF HINGE BRACKET AND LID SHOULD BE AS SHOWN AND AT THIS POINT THE HINGE ROD CAN BE INSERTED AND RETAINED IN POSITION USING A SELOC OR ROLL PIN THROUGH **ONE** OF THE HINGE BRACKETS.